



The Dexter 9 duplex has all the practical essentials required by those looking for a holiday home or a compact and manageable home for retirement.

As you enter the house, you step into the main living area through a modern undercover verandah. The open floor plan creates a bright and spacious feel, as the living, dining, and kitchen areas are all visible from the entrance. The living room has two large windows that let in plenty of natural light.

The back of the home houses the private areas including two bedrooms, a generous-sized laundry room with access to the homes garage, a bathroom plus a separate additional toilet.

The master bedroom has its own walk-in robe, with built-in storage units and its own access to the family bathroom. The second bedroom has a built-in robe and storage unit.

The floor plan of the Dexter 9 home includes the generous front aspect decking as well as a separate entrance from the garage via the laundry room. This floor plan is designed for modern living, and the compact, low-maintenance footprint allows you more time for the things you enjoy.

#### FEATURES PER HOME

Indoor Size (m <sup>2</sup> )	<b>86.4</b>
Number of Bathrooms	<b>1</b>
Number of Bedrooms	<b>2</b>
Number of Living Zones	<b>1</b>
Home Style	<b>Dual Occupancy</b>



*This floor plan is available when selecting any of the 3 Inclusions Packages.*

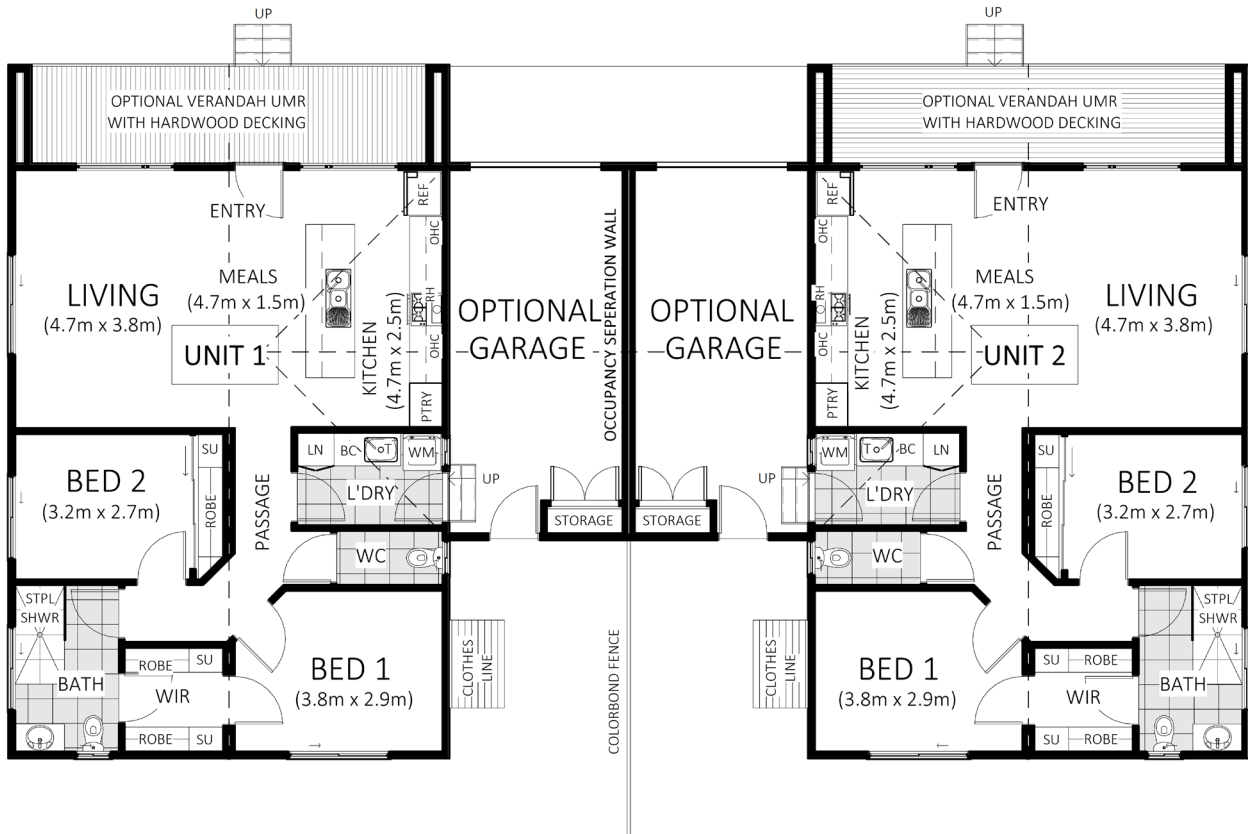

Swanbuild Dual Occupancy homes are ideal for owner-occupiers, creating a multi-generational home or building an investment opportunity.

At Swanbuild, we want to ensure your experience of building a new modular home is an exciting and rewarding process from start to finish. We offer a large range of floor plans and 3 inclusions packages to suit your lifestyle. Whether you're after a budget friendly first home, or a forever home packed full of premium inclusions, we'll help you get exactly what you need.

#### TAILORED UPGRADE OPTIONS\* INCLUDE:

- Ducted reverse cycle air-conditioning
- Downlights
- Fireplace
- Feature painted walls
- Extra WC in laundry
- 2pac Laminex profile doors
- Verandah/alfresco
- Feature glass entry door
- Architectural facade

Speak to our friendly sales team about designing and building your new Swanbuild home today.



1800 008 024



SALES@SWANBUILD.COM.AU

\*Tailored upgrades may incur additional costs and are only available when selecting a Life Made or Sustainable Living Package.